



KVASER ETHERCAN LIGHT HS

EAN 73-30130-00713-0

The Kvaser Ethercan Light HS is a CAN-to-Ethernet interface that facilitates the adoption of the Internet of Things (IoT) concept within modern manufacturing environments by enabling data from any CAN product or system to be accessed over the Internet, via an Ethernet-equipped PC.

Ethercan makes it easy to implement the Internet of Things (IoT) concept by enabling data from any CAN product or system to be sent over a corporate network or the Cloud, using the standard Kvaser API. The Kvaser Ethercan device can be configured with a static IP and comes with an Ethercan Factory Reset Device to reset the configuration to factory default DHCP settings at the push of a button.

KVASER ETHERCAN LIGHT HS

EAN 73-30130-00713-0

Major Features

- High-speed CAN connection (compliant with ISO 11898-2), up to 1 Mbit/s.
- Ethernet connection has auto-MDIX, so it automatically detects and adjusts for the Ethernet cable being used.
- Built-in Power over Ethernet (PoE) - receives data and power over the Ethernet cable.
- Small, lightweight plastic housing with galvanic isolation.
- Fully compatible with J1939, CANopen, NMEA 2000R and DeviceNet.
- Includes Ethercan Factory Reset Device. This device provides the ability to reset the Ethercan's IP address to factory defaults at the push of a button.

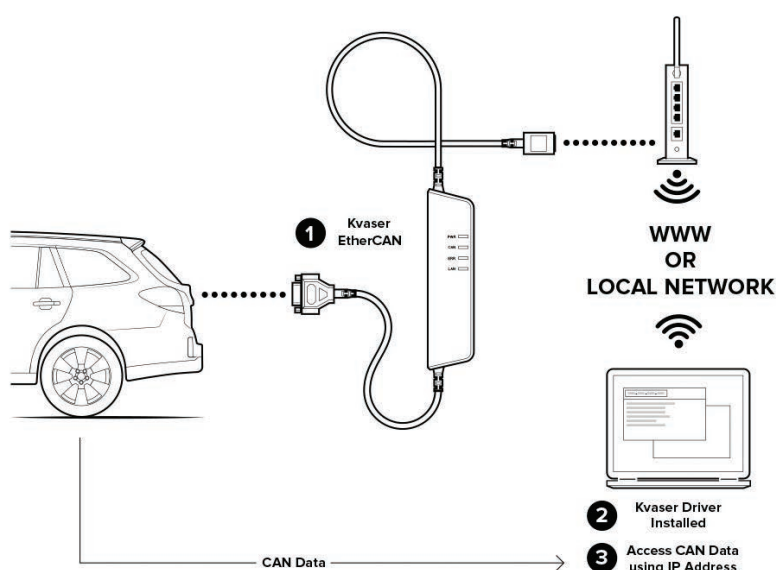

Technical Data

Bit Rate	40-1000 kbps
Temp Range	-20 - 70 °C
Messages Per Second Receive	8000 mps
Messages Per Second Sending	8000 mps
Weight	100 g
Length	165 mm
Height	17 mm
Channels	1
Certificates	CE, RoHS
Interfaces	Ethernet RJ45
OS	Windows 10, 8, 7 and Vista
Buffers	On Board Buffer
Galvanic Isolation	Yes
Error Frame Generation	No
Error Counters Reading	No
Silent Mode	No
Sound	No

WARRANTY

2-Year Warranty. See our General Conditions and Policies for details.

SUPPORT

Free Technical Support on all products available by contacting info@gmga.vn

SOFTWARE

Documentation, software and drivers can be downloaded for free, please contact us!

Kvaser CANlib SDK is a free resource that includes everything you need to develop software for the Kvaser CAN interfaces. Includes full documentation and many program samples, written in C, C++, C#, Delphi, Java, Python, and Visual Basic.

All Kvaser CAN interface boards share a common software API. Programs written for one interface type will run without modifications on the other interface types!

J2534 Application Programming Interface available.

RP1210A Application Programming Interface available.

Online documentation in Windows HTML-Help and Adobe Acrobat format.